

Cut and Bend Stainless Steel Reinforced Bar

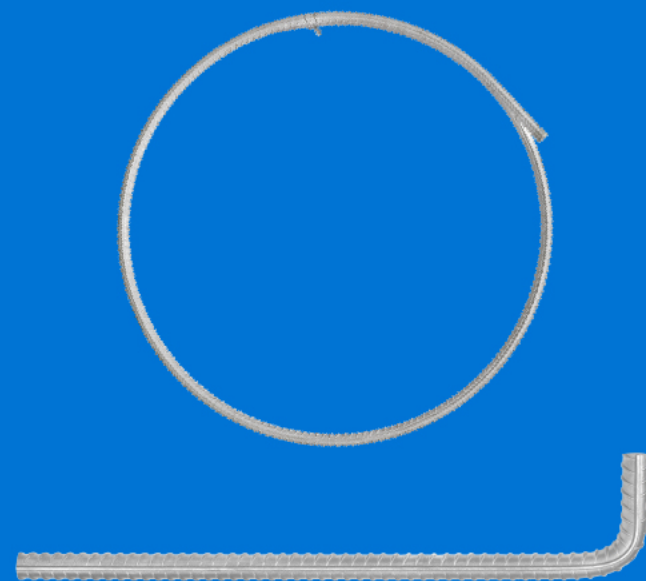

FUSTEEL

Typical Shape Codes to BS8666: 2005

00	11	12	13	15	21
25	26	31	33	41	44
46	51	67	77	99 Dimensional sketch required	

All other BS 8666:2005 shape codes available. Minimum radius and projected lengths are in Table 2 BS 8666:2005
Maximum radii for bending is in Table 6 BS 8666:2005

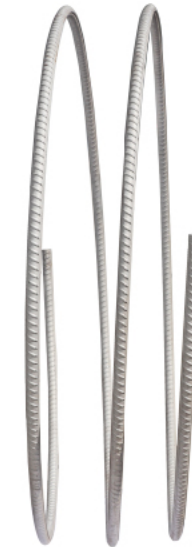

Tolerances on Cut and Bend Dimensions

Cutting of straight lengths (including reinforcement for subsequent bending)	±25mm
Bending:	
≤ 1m	±5mm
> 1m ≤ 2m	+5mm - 10mm
> 2m	+5mm - 25mm

Also available:

- BS 6744:2016 straight lengths up to 15m
- Stainless steel fabric mesh to BS 4483 mesh sizes
- Stainless steel dowel bars and sleeves
- Stainless steel rebar couplers
- Stainless steel wire
- Epoxy coated rebar

Nominal masses

Bar Diameter (mm)	Mass per metre (kg)	Metres per tonne (m)	Cross sectional area (mm ²)
8	0.392	2551	50.3
10	0.612	1634	78.5
12	0.882	1134	113.1
16	1.569	637	201.1
20	2.451	408	314.2
25	3.829	261	490.9
28	4.803	208	615.8
32	6.266	160	804.2
36	8.052	124	1017.9
40	9.790	102	1256.6
50	15.297	65	1963.5

Mass values are for steel designations 2304.

